

1). What is the purpose of drift in riveting operation?

- (A) To form the rivet head
- (B) To make the holes to be riveted
- (C) To align the holes to be riveted
- (D) To prevent damage to the rivet head

Correct Answer: C

2). What will be the result if the handy soldering copper bit is used on the light gauges of metal?

- (A) Metal will be buckled
- (B) Metal will be sheared
- (C) Metal will be wrinkled
- (D) Metal will be spring back

Correct Answer: A

3). Where is the sweat soldering process applied?

- (A) Reworking of ornaments
- (B) Electrical soldering work
- (C) Body repairing workshops
- (D) Joining of tool bits

Correct Answer: C

4). What is the name of the part marked as 'X' shown in the figure?

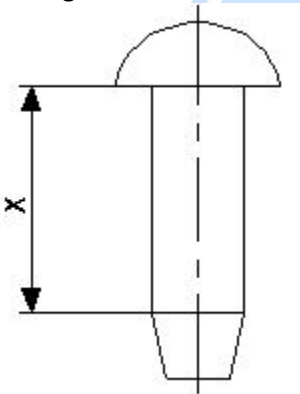

- (A) Tail
- (B) Body
- (C) Head
- (D) Diameter

Correct Answer: B

5). What is the melting temperature for soft soldering?

- (A) 500°C
- (B) Above 600°C
- (C) Below 420°C
- (D) 600°C

Correct Answer: C

6). What is the melting point range for silver alloys that is used as spelter in brazing?

- (A) 200°C - 400°C
- (B) 100°C - 200°C
- (C) 600°C - 850°C
- (D) 850°C - 1000°C

Correct Answer: C

7). Which type of material is used to make solder?

- (A) Welding rod
- (B) Synthetic element
- (C) Pure metal or alloy
- (D) Non metallic element

Correct Answer: C

8). Which rivet is used in heavy structural work?

- (A) Pan head rivet
- (B) Snap head rivet
- (C) Counter sunk rivet
- (D) Conical head rivet

Correct Answer: A

9). Which spelter is used for brazing of gold ornaments?

- (A) Silver solder
- (B) Copper solder
- (C) Tin lead solder
- (D) Lead solder

Correct Answer: A

10). Which powdered flux is used for soldering?

- (A) Resin
- (B) Zinc chloride
- (C) Hydrochloric acid
- (D) Ammonium chloride

Correct Answer: D



Industrial Training Institute

NCVT

GOVERNMENT OF INDIA