

- 1). Which wrench is used for tightening more than 50 mm diameter of pipe? (A) Strap wrench  
(B) Foot print wrench  
(C) Chain pipe wrench  
(D) Stilson pipe wrench

Correct Answer: C

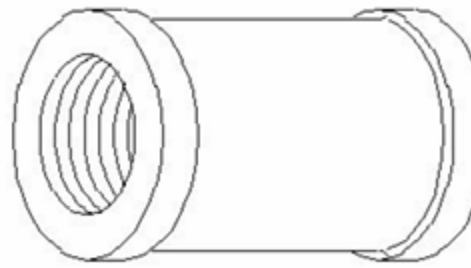

- 2). What is the name of the pipe fitting symbol shown in the figure?



- (A) Plug  
(B) Cross  
(C) Socket  
(D) Elbow

Answer: C

- 3). What is the angle of deviations provided on elbows and bends in pipe works?

- (A) 90° & 45°  
(B) 30° & 60°  
(C) 20° & 40°  
(D) 60° & 45°

Correct Answer: A

- 4). What is the name of the pipe fitting symbol shown in the figure?



- (A) Plug  
(B) Cross  
(C) Socket  
(D) Elbow

Correct Answer: A

- 5). Which standard fitting is used for joining pipeline of different diameters? |

- (A) Plug  
(B) Caps  
(C) Reducer  
(D) Coupling

Correct Answer: C

- 6). What is the name of the pipe fitting item shown in the figure?

- (A) Plug  
(B) Coupling  
(C) Reducer  
(D) Concentric reducer

Correct Answer: B

- 7). What is the name of the part marked as 'x' shown in the figure?

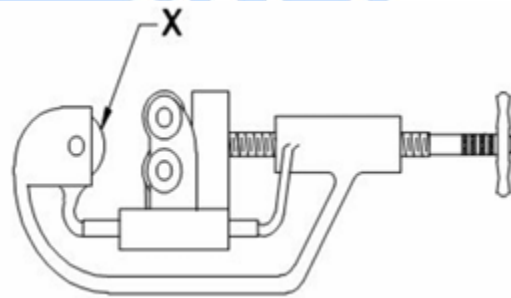

- (A) Cutter wheel  
(B) Adjusting screw  
(C) Guide rollers  
(D) Hand lever

Correct Answer: A

- 8). What causes a loud noise if a household water tap is turned on? (A) Washer loose in the valve

- (B) Air bleeding  
(C) No water in the tank  
(D) Blockage in the pipe line

Correct Answer: A

- 9). Why is the first rainfall of the season is not usually considered for rainwater harvesting?

- (A) Contains CO<sub>2</sub>  
(B) Contains dust particles in the air  
(C) Contains atmosphere pollution  
(D) Contains Silt

Correct Answer: D

- 10). What is the name of the pipe fitting shown in the figure?

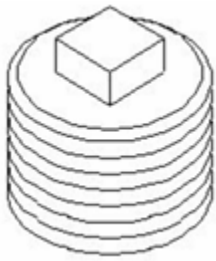

- (A) Plug
- (B) Coupling
- (C) Reducer
- (D) Concentric reducer

Correct Answer: A

11). What causes wobbling pipe cutter?

- (A) Worn out wheel
- (B) Damaged links
- (C) Worn out pin
- (D) Tension adjustment screw

Correct Answer: B

12). What is the name of the pipe fitting item shown in the figure?

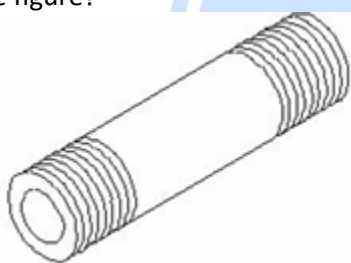

- (A) Close nipple
- (B) Short nipple
- (C) Long nipple
- (D) Connector

Correct Answer: C

13). What is the name of the pipe line symbol shown in the figure?

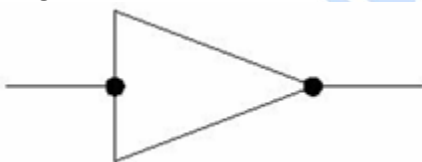

- (A) Socket
- (B) Plug or cap
- (C) Union screwed
- (D) Reducer concentric

Correct Answer: D

14). What causes water dripping from the tap even after it is closed? (A) Defective washer

- (B) Spindle thread wornout

(C) Bend spindle

(D) Loose valve

Correct Answer: A

15). What is the name of the part marked as 'x' shown in the figure?

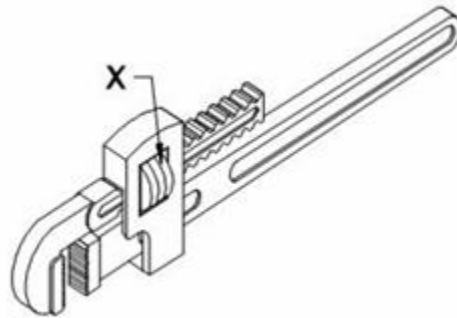

- (A) Pivot
- (B) Spring
- (C) Movable jaw
- (D) Adjusting nut

Correct Answer: D

16). Which valve permits fluid flow in only one direction?

- (A) Flow control valve
- (B) Needle valve
- (C) Non-return valve
- (D) Pressure regulator valve

Correct Answer: C

17). What is the name of the pipe fitting item shown in the figure?

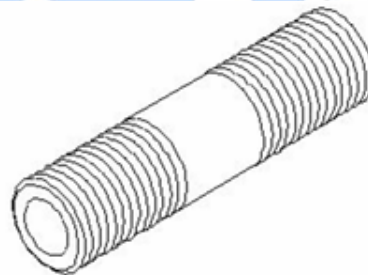

- (A) Close nipple
- (B) Short nipple
- (C) Long nipple
- (D) Connector

Correct Answer: B

18). How to arrest the leakage in pipe fitting?

- (A) By applying solution
- (B) By hem packing
- (C) By rapping with plastic wire
- (D) By fixing with quick fix

Correct Answer: B

19). How pipes are classified?

- (A) Uses
- (B) Colour
- (C) Shapes
- (D) Material

Correct Answer: D

20). What is the name of the pipe fitting item shown in the figure?



- (A) Close nipple
- (B) Short nipple
- (C) Long nipple
- (D) Connector

Correct Answer: A

